

MAHARASHTRA UNIVERSITY OF HEALTH SCIENCES, NASHIK

INFRASTRUCTURE DETAILS

Sr. No.	Particulars to be verified	Details on College Website	Adequate/ Inadequate
	College		
1	Land details: Total land, owner, unitary or not, NA of all land, 7/12 extracts of all land (Applicable only to Private Colleges). (Verify land documents & Government permissions documents are uploaded on College Website. No Land/ Construction documents shall be submitted to the University. Only deficit information to be pointed out to the University).	Yes	Adequate
2	Total constructed area of college building		
	(I) Administrative Section: Total Area 800sq.ft (which includes) Principal Room, P.A. Room, Reception cue Visitors lounge, Meeting hall, Account section, Record and Central store etc.	Yes	Adequate
	(II) Lecture Halls: a) Total No. of Lecture Halls .06 b) IT enabled, Audio / Video teaching Aids LCD Projector to every Class c) Total area for lecture Halls UG- 4320 PG -2160	Yes	Adequate
	(III) Seminar or Conference or Examination Hall: a) Total Area 2954.47.Sq.ft. b) Total Seating Capacity .250 c) Audio / Video System and Other Facilities Yes	Yes	Adequate
	(IV) Central Library: a) Total Area : 2443.51 sq.ft. Total No. of Books - 3895 Distribution of books Capacity of Reading Hall :- 2443.51sq.ft. for Students - 1202 sq.ft for Teachers – 498.51 sq.ft No. of Scientific Journals – 15 No. of News Papers - 06 Photo Copier Machine – Yes Drinking water & Washrooms- Yes b) Digital Library : Yes No. of Computers : 10 Internet Facility : Yes	Yes	Adequate
	(V) Teaching Departments: There shall be Five Teaching Departments as per MSR No. of departments- 05 Departmental Area, No. of Books/ Charts / Models / Specimens (dry and wet) / Museum in each department information to be uploaded on college website.	Yes	Adequate
	(VI) Laboratories : Laboratories : As per MSR (17079.43Sq.ft.) Nursing Foundation and Medical Surgical Nursing Lab (1500 Sq.ft.), CHN (900 Sq.ft.), Nutrition (900Sq.ft.), OBG and Paediatric (900Sq.ft.), Pre-Clinical Science (900Sq.ft.), Advanced Nursing Skill Lab (900Sq.ft.), Computer Lab (1500Sq.ft.), with 10 computer as per Intake capacity, AV Aids (600Sq.ft.), well Equipped Lab must have Mannequins, Articles & Beds as per MSR & INC Norms	Yes	Adequate
	(VII) Auditorium:- (As per MSR) Auditorium should be spacious enough to accommodate at least double the sanctioned/actual strength of students, so that it can be utilized for hosting functions of the college, educational conferences/ workshops, examinations etc. It should have proper stage with green room facilities. It should be well – ventilated and have proper lighting system. There should be arrangements for the use of all kinds of basic and advanced audio-visual aids. OR Multipurpose Hall:- College of Nursing should have multipurpose hall, if there is no auditorium.	Yes	Adequate

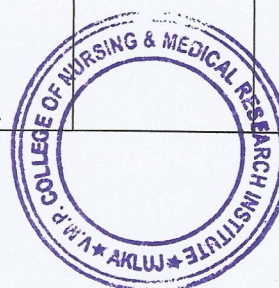

	(VIII) Canteen and Kitchen Facility: [Note: Verify Canteen Facility & Hygiene is monitored as per MUHS Circular No.18/2019 dated 19/03/2019.]	Yes	Adequate
	(IX) Common Rooms: Separate common rooms for boys and girls with adequate space and sitting arrangement shall be available.	Yes	Adequate
3	University Examination Infrastructure: Strong Room for examination a) (Area- 300 sq.ft, b) Shelf, c) Steel cupboard – 1, d) CCTV, Photocopier Machine, Examination hall with benches, Parking Facility for University vehicle, Guest house facility	Yes	Adequate
4	Other facilities: Hospital Waste Management, Medical Education Unit, Intercom Network, Playground, P.T Teacher or Instructor, Cafeteria, Facility for indoor games, Gymnasium / Gymkhana Facility, Is there any LMS (learning management system software) available	Yes	Adequate
5	Hostel facility: Boys (UG & PG), Girls (UG & PG), Interns, Residents, Warden/ Rector, Hygiene, Vending Machine etc.	Yes	Adequate
Hospital			
6	Hospital Details	Details on College Website	Adequate/ Inadequate
	Name of the Hospital : Ashwini Hospital , Akluj	Yes	Adequate
	Address: Sangramnagar, Akluj		
	Telephone No. : 02185 222357		
	Bed Strength : 100 Beds		
	Distance of Hospital from the College to which it is attached (in kms) 4.5 km	Yes	Adequate
	Number of beds registered as per BNH Act (100 Beds)	Yes	Adequate
7	I. Total constructed area of Hospital Building as per MSR (3000Sq.mtr. / Sq.ft.) Whether the Hospital is Owned by the College / Management or Rented ?	Yes	Adequate
	II. Hospital Administration Block as per MSR (Superintendent room, Deputy Superintendent room, Medical officers' room, Matron room, Assistant Matron room, Reception and Registration, etc.)	Yes	Adequate
	III. Out-Patient Departments (OPD) as per MSR Total Area of OPD Complex 1000Sq.ft. No. of OPD's -2 Facilities shall be as per MSR & all details shall be on college website.	Yes	Adequate
	IV. In Patient Departments (IPD) as per MSR Total Area of IPD Complex 24800Sq.ft. No. of IPD Departments- 6 Bed Distribution-100 Facilities shall be as per MSR & all details shall be on college website.	Yes	Adequate
	V. Operation Theatres Block as per MSR Total Area of OT Block-2000sq.ft. No.of OTs available-2 Facilities shall be as per MSR & all details shall be on college website.	Yes	Adequate
	VI. Casualty Facilities State Government Permission Letter	Yes	Adequate
	VII. Central Clinical Laboratory: Well-equipped with separate sections for Pathology, Biochemistry and Micro-biology. Attached toilet shall be there for collection of urine samples. Other diagnostic tools for ECG or TMT etc. shall be provided.	Yes	Adequate
	VIII. Radiology or Sonography Section: Radiologist chamber, X-ray room, Dark room, film drying room, store room, patients waiting and dressing room, reception or registration or report room.	Yes	Adequate
	IX. Labour Room :	Yes	Adequate



(Signature)
Dean/ Principal Stamp & Signature

PRINCIPAL
VIJAYSINH MOHITE-PATIL
COLLEGE OF NURSING & MEDICAL
RESEARCH INSTITUTE, AKLUJ

**Vijaysinh Mohite-Patil College of Nursing & Medical Research
Institute, Akluj
Details of Teaching Block**

Teaching Block	Required Area in sq.feet	Additional area in Sq.feet per student	Available
Total built up area in Sq Ft	59980	920	30194
Administrative Office	800	13	800
Lecture hall each for UG Program (Basic B.Sc Nursing)	4 X (1080) = 4320	15	4185.91
Lecture hall each for UG Program (Basic B.Sc Nursing +M.Sc.Nursing)	2 X(1080)2160	15	1639.78
One Classroom for clinical specialty Laboratories	300		300
Nursing Foundation Labs	1500		1998.23
CHN	900		950.6
Nutrition	900		950.6
OBG & Pediatric Lab	900		950.6
Pre Clinical Lab	900		950.6
Advance Clinical Lab for (PG) Programme	900		950.6
Computer lab	1500		960.80
Multipurpose hall/Auditorium	3000	50	2996.4
Common Room(Male & Female)	1000	17	245
Staff Room	1000	13	745.7
Principal Room	300	nil	480.4
Vice-Principal Room	200	nil	457.7
Library with Reading Room	2400	40	2442.6
AV aids Room	600	10	475.4
Room for head of department as 5 Specialties	5 x200=1000	nil	700
Faculty Room	2400	38	2200
Provision for toilets	1000	17	980
Strong room with grilled door facility	1000	nil	475.3
Total Requirement for Basic B.Sc Nursing Programme	57820		
Total Requirement for UG Program (Basic B.Sc.Nursing +M.Sc .Nursing	59980		26836.22





PRINCIPAL
VIJAYSINH MOHITE-PATIL
COLLEGE OF NURSING & MEDICAL
RESEARCH INSTITUTE, AKLUJ

**Vijaysinh Mohite-Patil College of Nursing & Medical Research
Institute, Akluj
Details of Hostel Block**

Sr. No	Blocks	Required Area in Sq Ft	Available
1	Number of students in a	One or two	11648
2	Total area of the room	24000	11648
3	Availability of Latrines & Bathrooms in each hostel	One Sanitary Latrine and one bathroom for 5 students	Washroom-25 , Bathroom-21 Total Students-50
4	Total area of Latrines and Bathrooms	500	1070
5	Visitor's room	500	700
6	Reading room	250	560
7	Store	500	317
8	Recreation room	500	966.66
9	Dining Hall	3000	1738
10	Kitchen & store	1500	858
11	Warden Room	450	450
	Total	31200	17984



PRINCIPAL
VIJAYSINH MOHITE-PATIL
COLLEGE OF NURSING & MEDICAL
RESEARCH INSTITUTE, AKLUJ

FRONT ELEVATION

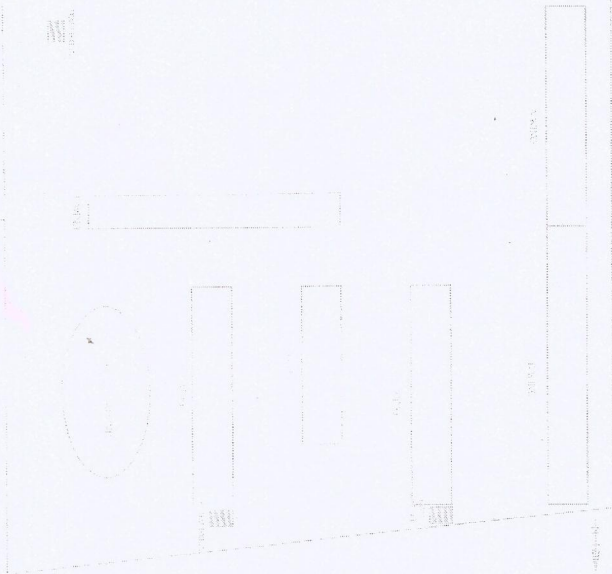
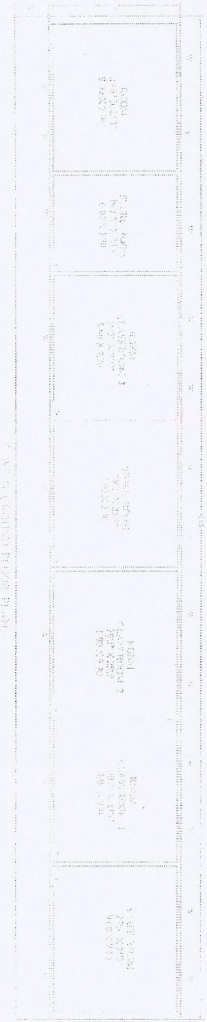
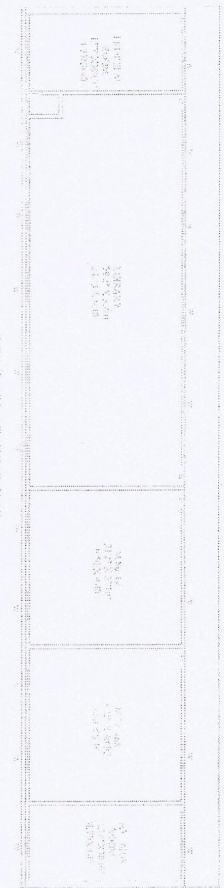
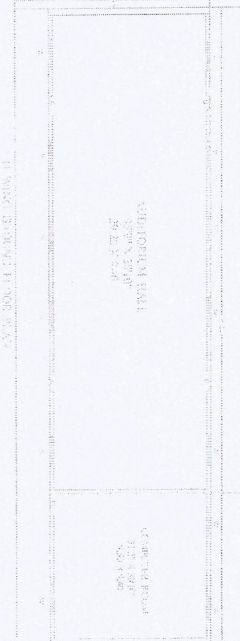
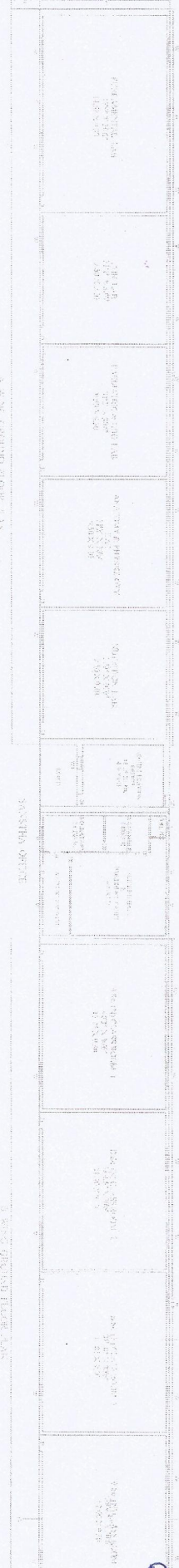

DEPARTMENT OF ARCHITECTURE
 V. J. SOMAIYA INSTITUTE OF ARCHITECTURE
 101, P. M. ROAD, AKLUJ
 DISTRICT - SURAT, GUJARAT
 PIN - 395 001
 TEL: 2612211, 2612212
 FAX: 2612213
 E-MAIL: vjsoi@vji.ac.in
 www.vji.ac.in
 V. J. SOMAIYA INSTITUTE OF ARCHITECTURE
 101, P. M. ROAD, AKLUJ
 DISTRICT - SURAT, GUJARAT
 PIN - 395 001
 TEL: 2612211, 2612212
 FAX: 2612213
 E-MAIL: vjsoi@vji.ac.in
 www.vji.ac.in

V. J. SOMAIYA INSTITUTE OF ARCHITECTURE
 101, P. M. ROAD, AKLUJ
 DISTRICT - SURAT, GUJARAT
 PIN - 395 001
 TEL: 2612211, 2612212
 FAX: 2612213
 E-MAIL: vjsoi@vji.ac.in
 www.vji.ac.in

Sl. No.	Particulars	Quantity	Rate	Amount
1
2
3
4
5
6
7
8
9
10
11
12
13
14
15
16
17
18
19
20
21
22
23
24
25
26
27
28
29
30
31
32
33
34
35
36
37
38
39
40
41
42
43
44
45
46
47
48
49
50
51
52
53
54
55
56
57
58
59
60
61
62
63
64
65
66
67
68
69
70
71
72
73
74
75
76
77
78
79
80
81
82
83
84
85
86
87
88
89
90
91
92
93
94
95
96
97
98
99
100

PRINCIPAL
VIJAYSINH MOHITE-PATIL
COLLEGE OF NURSING & MEDICAL
RESEARCH INSTITUTE, AKLUJ

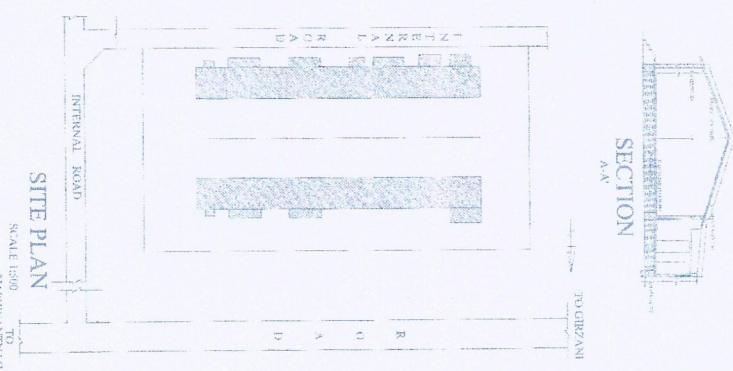
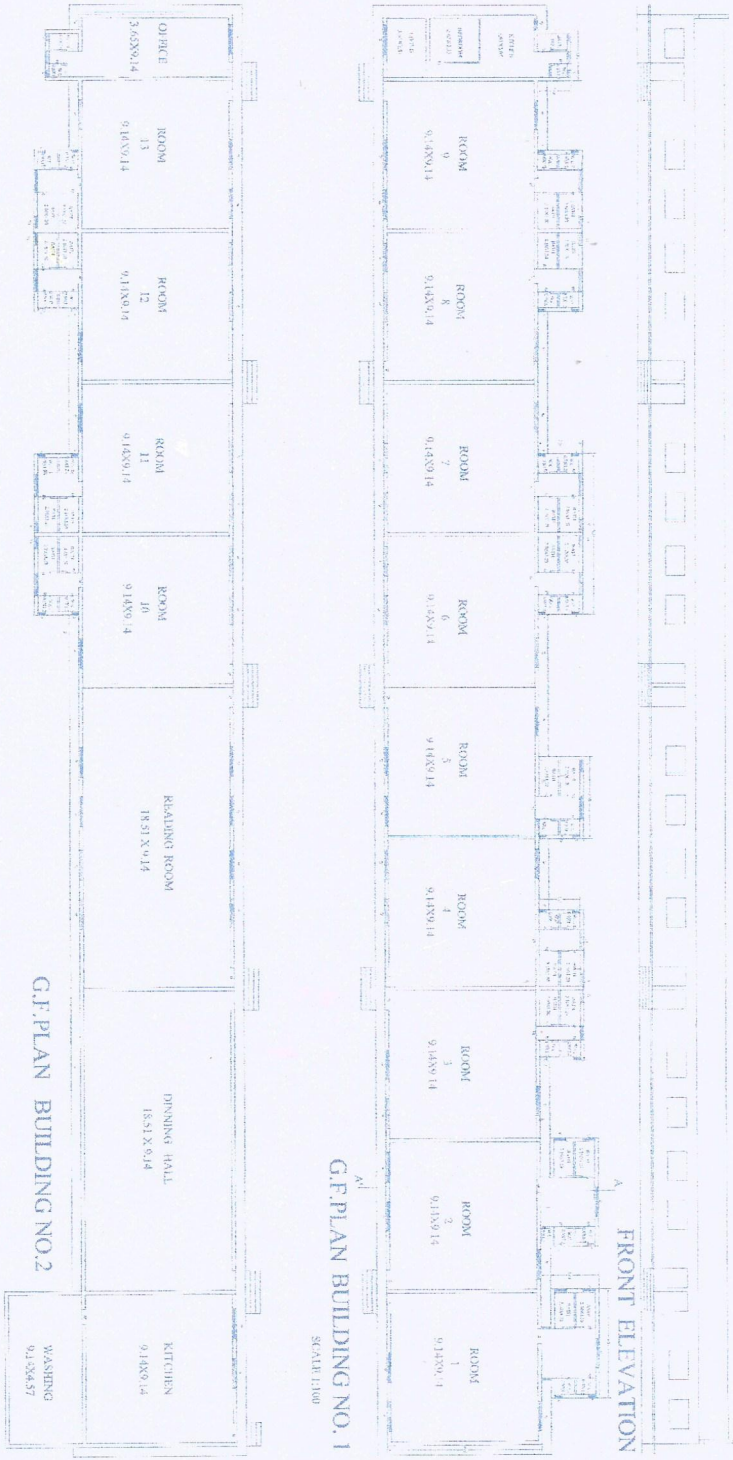

AREA STATEMENT

PLOT AREA -
 BUILT UP AREA -
 BLDG NO.1 - 58.42 X 9.60 = 568.63
 BLDG NO.2 - 58.42 X 9.60 = 568.63
 TOILETS -
 TOTAL - 1137.26
 TOTAL - 1056.25 SQ.M

OPENINGS

D - 1.22 X 2.15 - FLUSH DOOR WITH T.W. FRAME
 D1 - 6.90 X 2.15 - FLUSH DOOR WITH T.W. FRAME
 D2 - 6.90 X 2.15 - COATING DOOR WITH CADAPPA FRAME
 W - 1.82 X 1.22 - 2 TYPE STEEL WINDOW
 W1 - 1.81 X 1.22 - 4 TYPE STEEL WINDOW
 G1 - 1.52 X 0.96 - M.S. GRILL
 V - 6.45 X 0.60 - M.S. VENTILATORS
 V1 - 6.60 X 0.60 - M.S. VENTILATORS

SPECIFICATIONS

• FOUNDATION UP TO 1.50 M
 • LOAD BRACING STRUCTURE
 • 100% R.C.C. WITH 10% OVER RUN
 • 100% R.C.C. WITH 10% OVER RUN
 • ALL SHED ROOFING WITH STRUCTURAL SYSTEM
 • SHIMBARD ROOFING & TILES IN TOILETS
 • EXT. CLIMBING & INT. CORR. BOND DISTANCE

PROPOSED GIRL'S HOSTEL BUILDINGS
 FOR SHIVRATNA SHIKSHAN SANSTHA
 AT G. NO. 124/7A/1,
 CHOUNDE SHWARADI (YASHWANTNAGAR
 TAL-MAI SHIRAS, DIST-SOLAPUR.

S.K.PATALE
 CONSULTING CIVIL ENGINEER & ARCT
 YASHWANTNAGAR, AKLUI

DRAWN BY	SCALE	CHECK BY	NORTH
S.N.PATIL	AS SHOWN		

S.K.PATALE
 CONSULTING CIVIL ENGINEER & ARCT
 YASHWANTNAGAR, AKLUI

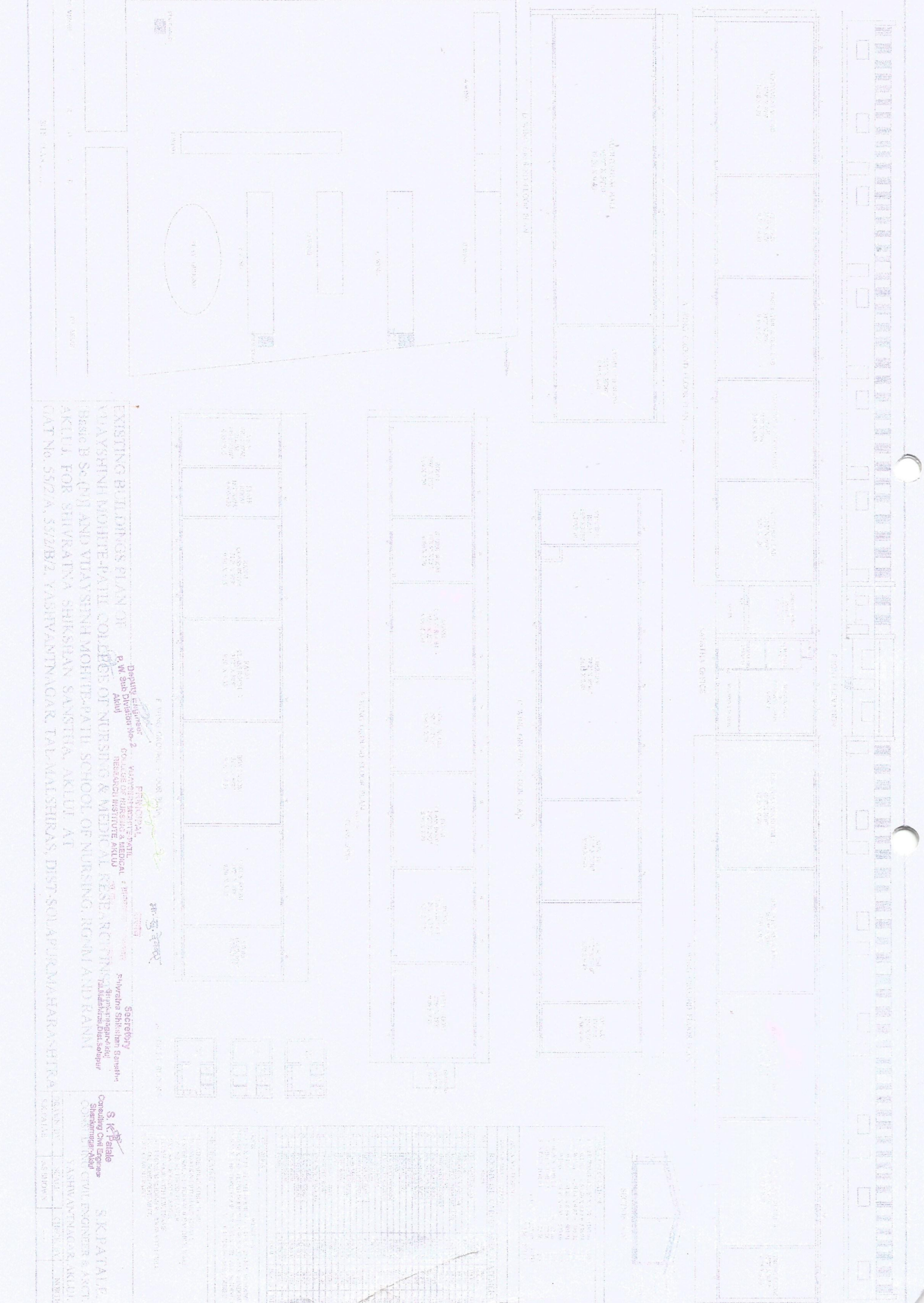

EXISTING BUILDINGS PLAN OF
YASHVINI MOHITE-PATE COLLEGE OF NURSING & MEDICAL RESEARCH
 BASED ON (M) AND YASHVINI MOHITE-PATE SCHOOL OF NURSING, ROUNI AND RANI
 AKLI, FOR SHIVRATI SHRISRI SANATHA, AKLI, AT
 GAT No. 55/2/A, 55/2/B/2, YASHVANTNAGAR, TAL. WALSHIRAS, DIST. SOLAPUR, MAHARASHTRA

Deputy Engineer - 2
 P. M. Sub Division No. 2
 Akli

Project Officer
 P. M. Sub Division No. 2
 Akli

Secretary
 Shivratna Shrisri Sanatha
 Akli

S. K. Patil
 Consulting Civil Engineer
 Shivratna Shrisri Sanatha
 Akli

S. K. Patil
 S. K. Patil
 CIVIL ENGINEER & ARCHT.
 SHIVRATNAGAR, AKLI.

DATE	SCALE	CHECKED BY	REVISION
15/05/2024	1:100	S. K. PATIL	1
15/05/2024	1:100	S. K. PATIL	2
15/05/2024	1:100	S. K. PATIL	3
15/05/2024	1:100	S. K. PATIL	4
15/05/2024	1:100	S. K. PATIL	5
15/05/2024	1:100	S. K. PATIL	6
15/05/2024	1:100	S. K. PATIL	7
15/05/2024	1:100	S. K. PATIL	8
15/05/2024	1:100	S. K. PATIL	9
15/05/2024	1:100	S. K. PATIL	10

**VIJAYSINH MOHITE PATIL COLLEGE OF NURSING
AKLUJ**

Anatomy lab Inventory

Sr. No.	Name of article	Available quantity
A	Bones	
1.	Humerus	02
2.	Ulna	02
3.	Radius	02
4.	Scapula	02
5.	Clavicle	02
6.	Fibula	02
7.	Femur	02
8.	Acetabullum	02
9.	Tibia	02
10.	Wrist	01
11.	Foot	01
12.	Skull	01
13.	Ribs	11 pair
B	Joints	
14.	Shoulder joint	01
15.	Elbow joint	01
16.	Hip joint	01
17.	Wrist joint	01
18.	Ankle joint	01
19.	Foot joint	01
c	Models	
20.	Sternocostal cartilage model	01
21.	Spinal nerves with vertebrae	01
22.	Human teeth	01
23.	Pelvis	01
24.	Heart, liver and intestine	01
25.	Male reproductive organs	01
26.	Urinary system	01
27.	Digestive system	01
28.	Transparent lungs	01
29.	Heart, liver, intestine, lungs and thyroid	01
30.	Female reproductive system	01
31.	Skin	01
32.	Eye	01
33.	Larynx	01
34.	Male genital model	01

35.	Heart	01
36.	Liver, pancreas and spleen	01
37.	Brain	01
38.	Anatomy dissection kit	0
39.	Full size of human body /tarso – impetrated showing all muscles and arteries	0
40.	Microscope	0
41.	Jumbo heart	0
42.	Nasal cavity	0
43.	Uterus	0
44.	Brain model	01
D	Dissection organs	
45.	Lungs	Discarded
46.	Liver	
47.	Gall bladder	
48.	Heart	
49.	Small and large intestine	
50.	Urinary bladder and kidney	
51.	Spleen	
E	Charts	
52.	Female reproductive system	01
53.	Human liver	01
54.	Arterial system	01
55.	Human ear	01
56.	Human skin	01
57.	Structural anatomy of eye	01
58.	Venous system	01
59.	Head and neck	01
60.	Muscular system	01
61.	Ear, nose and throat	01
62.	Human Brain	01
63.	Human skull	01
64.	Hand and wrist	01
65.	Hip and knee	01
66.	Foot and ankle	01
F	Skeleton	01
G	Weighing machine	01

Other Inventory

1.	Table (small)	01
2.	Table (large)	04
3.	Chairs	04
4.	Bed sheets (white)	12
5.	Fan wall	02

6.	Cooler	01
7.	Racks	02
8.	Cupboard (small)	02
9.	Cupboard (large)	01
10.	Notice board	01
11.	Computer (P.C.)	01

[Handwritten Signature]
Lab Incharge

[Handwritten Signature]
613122
Lab Incharge (central)

[Handwritten Signature]
principal
PRINCIPAL
VIJAYSINH MOHITE-PATIL
COLLEGE OF NURSING & MEDICAL
RESEARCH INSTITUTE, AKLUJ



FUNDAMENTAL AND MEDICAL SURGICAL LAB

SR.NO.	NAME OF INSTRUMENT /ARTICLES	QUANTITY
1	Cupboard	1
2	Racks	6
3	Cot	8
4	Semi Fowler Bed	2
5	Bedside Locker	9
6	Wheel Chair	1
7	Bed Side Screen	2
8	Oxygen Cylinder	1
9	Oxygen Trolley	1
10	Instrumental Trolley	1
11	Suction Machine	1
12	Dressing Trolley	1
13	IV Stands	5
14	Male Dummy	2
15	Female Dummy	1
16	CPR Dummy (Male)	1
17	Mattress	9
18	Pillow	7
19	Pillow Cover (White)	6
20	Blanket (Top Sheet)	12
21	Rug	9
22	Bed sheet White	16
23	Draw sheet White	4
24	Surgical Gown	7
25	Surgical Pant And Shirt	5
26	Surgical Drapes (Green)	21
27	Surgical Cap	10
28	Rubber Sheet	2
29	Macintosh Sheet	26
30	Cloth Roller Bandage	4
31	Cloth Triangular Bandage	1
32	Cotton Pad (Swab)	1
33	Gauze Piece Bundle	2
34	Sanitary Pad	0
35	Crape Bandage	0
36	Foot Drop Splint	1
37	Stethoscope	4
38	B.P.Appratus	10

39	Dial Regulator B.P Apparatus	0
40	Weight Machine	5
41	Clinical Thermometer	3
42	Lactometer	2
43	Laryngoscope With 4 No. Blade	1
44	Laryngoscope With 2 No. Blade	1
45	Otoscope	1
46	Towel	1
47	Napkin	0
48	Sponge Bath Napkin	0
49	Steel Jug	8
50	Dressing Drum 6x6	3
51	Dressing Drum 10x8	3
52	Steel Basin	9
53	Steel Bed Pan	1
54	Steel Tray 12x8	5
55	Steel Tray 11x7	0
56	Steel Tray 8x6	1
57	Steel Kidney Tray Large	6
58	Steel Kidney Tray Medium	6
59	Steel Kidney Tray Small	1
60	Steel Large Bowl	0
61	Steel Small Bowl	1
62	Enamel Basin	3
63	Enamel Bowl	3
64	Enamel Tray 12x10	5
65	Enamel Tray 12x18	2
66	Enamel Tray 16x18	0
67	Enamel Tray 8x6	0
68	Enamel Tray 14x12	0
69	Plastic Kidney Tray	4
70	Plastic Basin	3
71	Plastic Enamel Can	10
72	Plastic Measuring Jug 1000ml	3
73	Plastic Bed Pan	4
74	Plastic Sputum Cup	4
75	Plastic Test Tube Stand	1
76	Metal Test Tube Stands	4
77	Test Tube Holder	6
78	Spirit Lamp	4
79	Dropper	0
80	Hot Water Bag	4

81	Ice Bag	5
82	Air Cushion	0
83	AMBU Bag	2
84	Suction Catheter No.12	0
85	Suction Catheter No.14	1
86	Suction Catheter No.16	1
87	Foleys Catheter No.8	1
88	Foleys Catheter No.10	1
89	Foleys Catheter No.12	0
90	Foleys Catheter No.14	1
91	Foleys Catheter No.16	0
92	Ryles Tube No.20	2
93	Ryle's Tube No.18	1
94	Et Tube No.8	1
95	Et Tube No.7	1
96	Et Tube No.8.5	0
97	Et Tube No.7.5	0
98	Urine Drainage Bag	2
99	B T set	1
100	Drip Set	1
101	Oxygen Mask	3
102	Drip Set Pediatric	0
103	Scalp Needle	1
104	Three Way	1
105	Iv Set	1
106	Spinal Needle	1
107	Syringe 2ml	20
108	Syringe 5ml	15
109	Syringe 10 Ml	2
110	Syringe 20ml	2
111	Syringe 50 Ml	2
112	Insulin Syringes	0
113	Tuberculin Syringes	0
114	Nelson Inhaler	3
115	Crusher	2
116	Feeding Cup Big	3
117	Feeding Cup Small	8
118	Disposable Gloves Box	0
119	Comb	0
120	Soap Dish	1
121	Normal Saline Bottle	0
122	Beta dine Bottle	1

123	Talk Purified Bottle	0
124	Savlon Bottle	0
125	Sodium Bicarbonate	0
126	Plastic Bucket	15
127	Nail Brush	9
128	Douche Set	1
129	Plastic Vaporizer	1
130	Milk Sucker	6
131	Sputum Steel Cup	4
132	Plastic Tray	5
133	Splints(Large)	2
134	Monitor	1
135	Measuring Cup 125 Ml	1
136	Measuring Cup 50 Ml	1
137	Measuring Cup 250 Ml	1
138	Wolfes Bottle	0
139	Vacutainer And Test Tubes	2
140	Funnel Big	1
141	Enema Can With tubing	8
142	Enema Can Without Tubing	0
143	Thigh Bandage 6 Cm	0
144	Thigh Bandage 8 Cm	0
145	Donuts	1
146	Head Ring	0
147	Ear Irrigation Syringes	0
148	Eye Shield	1
149	Eye Wash Cup	0
150	Biopsy Needle	1
151	Bio Hazard Container	1
152	Proctoscope	0
153	Pharyngeal Airway	1
154	Oxygen Connector	1
155	Bi-pap Mask	1
156	Pie Dish	0
157	Fenestrated Towel (Blue)	0
158	Pediatric Cloths	0
159	Bath Thermometer	0
160	Mortar And Pestle	0
161	Water Seal Drainage	1
162	Basin (Steel)	5
163	Basin (Enamel)	2
164	Basin (Plastic)	3

165	Lid	2
166	Blue Sheet	0
167	Ice Cup Cover	1
168	Splints (Small)	1
169	Intracath No.20	2
170	Intracath No.18	0
171	Intracath No.24	0
172	Intracath No.22	0
173	Sterile Gloves No 7	1
174	Steel Dabby	0

Bamble
LAB INCHARGE

Order 815122
ALL LAB INCHARGE

Vijay Patil
PRINCIPAL

PRINCIPAL
VIJAYSINH MOHITE-PATIL
COLLEGE OF NURSING & MEDICAL
RESEARCH INSTITUTE, AKLUJ



VIJAYSINH MOHITE PATIL COLLEGE OF NURSING AND MEDICAL RESEARCH INSTITUTE,
AKLUJ

MATERNAL AND CHILD HEALTH (MCH) LAB

SR.NO	NAME OF ARTICLE	AVAILABLE QUANTITY
1.	Stages of G&D of embryo	09
2.	Female pelvis	03
3	Fetal Skull	02
4.	Placenta model	02
5.	Full size baby	03
6.	Fetal circulation	01
7	Enamel tray (Big)	03
8	Enamel tray (Medium)	02
9.	Enamel tray (small)	02
10.	Steel tray (small)	03
11	Steel tray (Medium)	02
12	Steel tray (Big)	04
13.	Medication tray (small and big plastic)	02
14.	Vaginal speculum	02
15.	BP Handle	03
16.	Cheatele forceps	04
17.	Artery forceps (straight 4 & curved 7)	11
18.	Allies forceps / Varesellum	1-1
19.	Needle holder	04
20	Uterine sound & Bladder sound	02
21.	Ovum forceps	02
22.	Sponge holder	01
23.	Dilators	17
24.	Short curved obstetric forceps	01
25.	Episiotomy scissors	01
26.	Retractors	01
27.	Vaginal Speculum (Cusco)	04
28.	Tooth forceps (with tooth 08, without tooth 07)	15
29.	Suture cutting Scissors	12
30.	Uterine Curette	02
31.	Hammer	01
32.	Pessary (plastic)	01
33.	Tooth Artery forceps	02
34.	Kocher's forceps	01
35.	Catheters	01
36.	Fetoscope	06
37.	Intact Ambu – Bag (small)	01
38.	Steel bed Pan	03
39.	Plastic bed Pan	01
40.	Small plastic Buckets	12
41.	Nebulizer	01
42.	Electronic weight Machine	01

43.	Infant Meter	01
44.	IV stand	01
45.	Bed side locker	01
46.	Baby Receiving Tray	01
47.	Adult Stethoscope	02
48.	Pediatric Stethoscope	02
49.	Mucus Aspirator	03
50.	Kidney tray steel (Small)	04
51.	Kidney tray steel (Medium)	14
52.	Kidney tray steel (Big)	02
53.	Kidney tray Plastic	02
54.	Soap box	04
55.	Glass (Steels)	04
56.	Small steel Bowl	03
57.	Medium steel Bowl	10
58.	Large Steel bowl	09
59.	Glass (steel)	04
60.	Basin (plastic)	02
61.	Linen White	04
62.	Draw sheet (Green)	01
63.	Hole towel (blue)	05
64.	Green Gown	03
65.	Hole towel (Green)	02
66.	Pillow with cover	01
67.	Mackintosh	05
68.	Towel (Small)	03
69.	Fertilization process Model	01
70.	Fetus with Viscera and placenta	01
71.	Fetus skull and pelvis is attached	01
72.	Episiotomy model	03
73.	Nipple shield Silicon	02
74.	Splint plastic	02
75.	Baby cloth	01
76.	Test tube stand (steel& Plastic)	1-1
77.	Glass test tube (Small)	03
78.	Glass test tube (big)	04
79.	Sprit lamp	01
80.	Test tube holder	01

81.	Baby mattress with net	01
82.	Baby Cap	01
83.	Privacy curtain	01
84.	Delivery bed (with model 1& empty 1)	02
85.	Patient bed	01
86.	Enema can	01

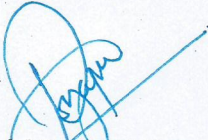
LAB-IN CHARGE

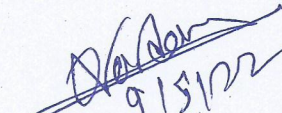
9/5/22
ALL LAB-IN CHARGE

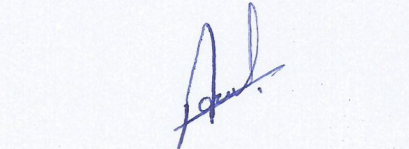
PRINCIPAL
PRINCIPAL
VIJAYSINH MOHITE-PATIL
COLLEGE OF NURSING & MEDICAL
RESEARCH INSTITUTE, AKLUJ



**VIJAYSINH MOHITE PATIL COLLEGE OF NURSING AND
MEDICAL RESEARCH INSTITUTE, AKLUJ**

NUTRITION LAB

SR. NO.	NAME OF ARTICLE	QUANTITY
1.	GAS STOVE	03
2.	CYLINDER	04
3.	GAS LIGHTER	02
4.	GAS VESSEL HOLDER	01
5.	MICROWAVE OVEN	01
6.	REFRIGERATOR	01
7.	WATER FILTER	01
8.	WATER TANKS	03
9.	DINNING TABLE WITH CHAIR	01
10.	STEEL POT	02
11.	STEEL RACKS	02
12.	WOODEN TABLE	01
13.	GAS STOVE STAND TABLE	02
14.	PRESSER COOKER	02
15.	PLASTIC VEG STAND	01
16.	STEEL BASIN	01
17.	STEEL COFFEE MAKER	01
18.	STEEL TAMBE	08
19.	STEEL GLASS	17
20.	DINNER STEEL PLATES	15
21.	SMALL STEEL PLATES	26
22.	SMALL STEEL BOWEL	16

23	BIG VESSEL	03
24	KADAI	05
25	PLASTIC BOX	02
26	PULSES BOX	12
27	COFFEE FLASK STEEL	01
28	STEEL TIFFIN PLATES	13
29	PLASTIC DINNER PLATES	10
30	DINNER SET	02
31	TRAY (PLASTIC & STEEL)	02
32	SOCCOR	01
33	WATER DRINKING GLASS	14
34	PLASTIC JUGS	04
35	PLASTIC GLASSES	16
36	SEPARATE TEA CUP	00
37	CHAPATI MAKER	04
38	TAVA	01
39	VEGETABLE CUTTER	01
40	BUTTER MILK MAKER	02
41	LEMON SQUEEZERS	01
42	CHIPS MAKERS	01
43	SAMBHAR SPOON (STEEL)	01
44	RICE SPOON (STEEL)	01
45	CHAPATI / ROTI STEEL SPOON	01
46	FRY USING SPOON	01
47	STEEL SPOON STAND	01
48	SMALL SPOON STEEL	07
49	GOWN	02
50	FRUIT BOX (PLASTIC)	01

51	PLASTIC FRUITS	18
52	STEEL VESSELS	02
53	MIXER	02
54	TEA SET PLATES	22
55	TEA CUP	13
56	STEEL GHAMELE	07
57	PLASTIC GHAMELE	01
58	ALUMINIUM GHAMELE	01

[Signature]
2/5/22

LAB – INCHARGE

[Signature]
2/5/22

ALL LAB – INCHARGE

[Signature]
2/5/22

PRINCIPAL

PRINCIPAL

VIJAYSINH MOHITE-PATIL
COLLEGE OF NURSING & MEDICAL
RESEARCH INSTITUTE, AKLUJ



**VIJAYSINH MOHITE PATIL COLLEGE OF NURSING AND
MEDICAL RESEARCH INSTITUTE, AKLUJ**

COMMUNITY HEALTH NURSING LAB

Sr. No.	Name Of Article	Quantity
1.	Height scale	1
2.	Steel tray	4
3.	Community bags	60
4.	Delivery kit	2
5.	HIV rapid test kit	1
6.	Fetoscope	43
7.	Hemoglobin meter	2
8.	Thermometer	30
9.	Charts	5
10.	Various environmental sanitation model	5
11.	Malaria life cycle model	1
12.	Infant meter	10
13.	Stethoscope	36
14.	B. P. Apparatus	2
15.	Test tube holder	45
16.	Test tubes	43
17.	Box with cotton swab	1 box
18.	Solution bottles of	1 box
19.	Betadine solution	2
20.	Acetic acid	1
21.	Spirit	3
22.	Spirit lamp	45
23.	Bottle with cotton balls	6
24.	Specimen bottles	12
25.	Stool specimen bottles	6
26.	Soap dish	30
27.	Dettol	2
28.	Betadine	2
29.	Uros trip bottle	2
30.	Funnel (big)	2
31.	Funnel (small)	2
32.	Measuring cup	2
33.	Stapler with pins	1
34.	Pocket diaries	3

35.	Steel bowls small	10
36.	Kidney tray	20
37.	Paper clips	20
38.	Box with hand towel	1 box
39.	Weighing machine	2
40.	Box with bottles	1
41.	Box with clean gloves	1

Vijay Patil
11/15/22
LAB INCHARGE

Vijay Patil
11/15/22
ALL LAB INCHARGE

Vijay Patil
PRINCIPAL
PRINCIPAL
VIJAYSINH MOHITE-PATIL
COLLEGE OF NURSING & MEDICAL
RESEARCH INSTITUTE, AKLUJ



SHIVRANTNA SHIKSHAN SANTHA'S
VIJAYSINH MOHITE PATIL COLLEGE OF NURSING &
MEDICAL RESEARCH INSTITUTE, AKLUJ.

A.V AIDS LAB EQUIPMENTS

Sr.No	Name of Equipments	Available Quantity
1	Charts on Wall	18
2	2D Flow Chart Model	01
3	Puppets	08
4	OHP Transparancy	02
5	3D Model	01
6	Projector Screen	01
7	Bulletin Board	04

LAB INCHARGE SIGN

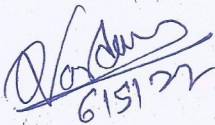
6/13/22
ALL LAB INCHARGE SIGN

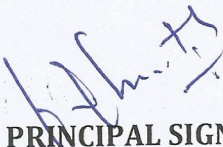
PRINCIPAL SIGN
PRINCIPAL
VIJAYSINH MOHITE-PATIL
COLLEGE OF NURSING & MEDICAL
RESEARCH INSTITUTE, AKLUJ



**VIJAYSINH MOHITE PATIL COLLEGE OF NURSING &
MEDICAL RESEARCH INSTITUTE, AKLUJ**

COMPUTER LAB LIST

Date:-7/5/2022

SR NO	NAME OF EQUIPMENT		CURRENT
1	Monitor		12
2	CPU	old	10
		New	2
3	Mouse		4
4	Keyboards		10
5	Cables	Blue	10
		Black	30
6	Printer	Small	3
		Big	1

[Signature]
PRINCIPAL

**PRINCIPAL
VIJAYSINH MOHITE-PATIL
COLLEGE OF NURSING & MEDICAL
RESEARCH INSTITUTE, AKLUJ**

[Signature]
LAB INCHARGE

